

Closure Systems

Advancements in hip disarticulation prosthetics require a pelvic fastener which can maintain the integrity of a two-piece socket system while simultaneously enabling tight closing.

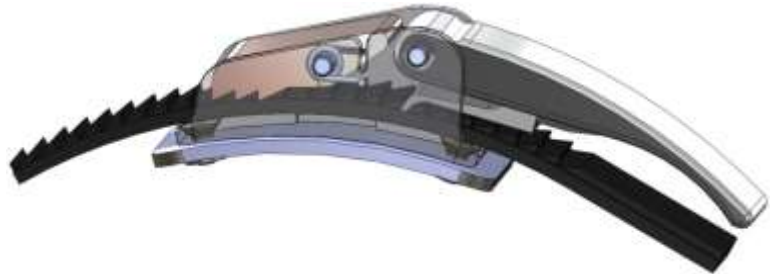

Upper Illustration: Mammut-mittel
Lower Illustration: Gleiter-mittel

Other Special Features

- Gleiter model has **replaceable slide rails** to service wear.
- Developed for use with **pre-preg** technology.
- Stainless steel tunnel and base plate **can be opened** from inside.
- Weight classification ensures system is stable **even with large patients**.
- Gleiter rotational stiffness permits **reliable walking and standing**.

Functions

	Tightening of the pelvic socket.
Mammut	“Back” securely maintains closed position .
	Can be locked in the open position.
	Guiding slide rails assist donning and doffing.
Gleiter	Tongue and tunnel provide anterior / posterior stability .
	Tongue and tunnel provide proximal / distal stability .

Silicone Frame Socket

This ischial ramus containment socket fastens the pelvis diagonally on both sides between the iliac crests and the ischial tuberosity. This technique has been realized by Udo Danske. A **silicone liner** in the shape of a swimsuit is fashioned in order to spread out the forces and protect the skin. Then a two-piece rigid frame fastening both ilia is fabricated. The iliac crest and spine are left uncovered and an opening is provided at the level of the acetabulum. Posteriorly, the socket is trimmed so that the frame lies on the sacrum but lumbar vertebrae are left free. **The Gleiter** at the sacral level maintains the stability of the rigid two piece frame while **the Mammut**, positioned on the side, holds the socket together and enables donning of the prosthesis.

Article-No.	Closure System		
	Gleiter-groß	Gleiter-mittel	Gleiter-klein
	Mammut-groß	Mammut-mittel	Mammut-klein
* Body Weight	Up to 120 Kg	Up to 85 Kg	Up to 50 Kg
** Pelvic Width	from 32 cm to 39 cm	from 26 cm to 33 cm	from 20 cm to 27 cm

☐ * **Attention!** The weight classification system we use to determine joint selection assumes “normal” body proportions. If your patient varies from these proportions, e.g. tall / slim or short / sturdy, please contact us to determine the proper selection.

☐ ** The pelvic width is measured ½-way between the trochanter and iliac crest. 5mm padding is taken into consideration.



Frame socket with skin colored silicone liner.

Illustration from www.geh-vision.de



Blue silicone liner