

Konso Knee Joint



Features

Sizes available for **small to large** patients

Additional functions with the **Move-N** oder **Move-S** add-ons

Joint flexes to **140°**

Available with a **long or short upright**

+ Thigh segment **angled 5° outwards**

Ball plunger included for temporary unlocking of joint

Fabricated from **high-strength aluminum**

+ **Adjustable flexion angle** from **0° to 40°** in 5° intervals

Also available with a **straight lower bar** for easier separation of the thigh from calf section

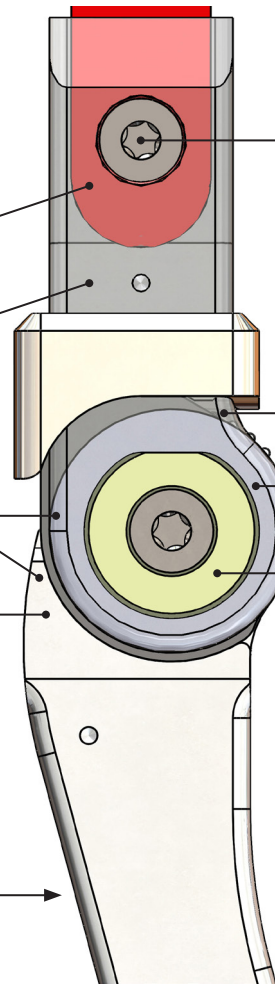

Standard

Fully assembled as one item for clear cost estimates and uncomplicated ordering

Machined uprights and offset connection ensure **optimal transfer of force**

Upper section **CNC-machined from one piece** of material for increased stability

Precise assembly calibrated to 1/100mm with self-lubricating washers for smooth operation free of play

Maintenance-free stainless steel joint assembly with bronze bushing

Unrivalled **20-month guarantee**

Engraved **serial number** for traceability

Clearly illustrated instructions for use

Fig. left

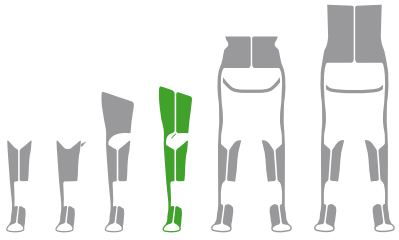

We recommend using our configurator to make your selection.
The configurator considers, among other factors, weight to height ratios.

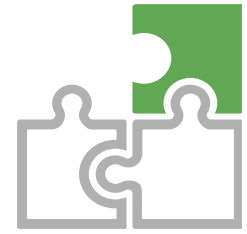

Weight Classification (body weight)

Joint

Article No.	KAFO	Width	Thickness	Drop Lock Thickness
Konso-25	up to 20 kg	25 mm	14,5 mm	17,5 mm
Konso-28	up to 30 kg	28 mm	16,5 mm	20,5 mm
Konso-30	up to 35 kg	30 mm	17,5 mm	21,5 mm
Konso-32	up to 50 kg	32 mm	19,5 mm	23,0 mm
Konso-36	up to 70 kg	36 mm	20,5 mm	24,0 mm
Konso-40	up to 85 kg	40 mm	22,0 mm	26,0 mm

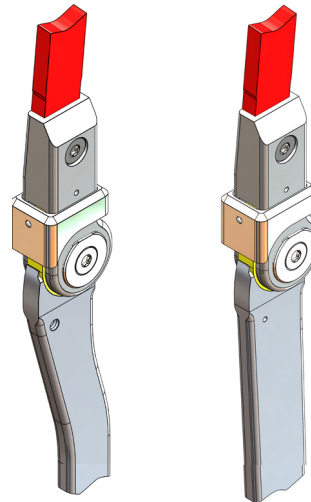

Konso contoured | Konso straight

 Locked	 Extension	 Flexion	Posterior Offset	 Modular	Force Options	 No Grinding Necessary	Noise Dampening	 Water Resistant
------------	---------------	-------------	------------------	-------------	---------------	---------------------------	-----------------	---------------------