

# Fokus 3D Hip Joint



## Features

- Sizes available for **infants to large** patients
- Upper section fabricated from **high-strength aluminium**
- Joint flexes to **130°** when unlocked for sitting
- + **Adduction is blocked**. 12° flexion stop can be increased as required for step length.
- + **Pelvic rotation** for efficient and energy saving gait. Joint axis permits **12° of internal and 12° of external rotation** independent of flexion/extension
- + **12° of abduction** increases stance stability and makes sitting more comfortable
- + Lower section made of high-strength, **hardened steel**

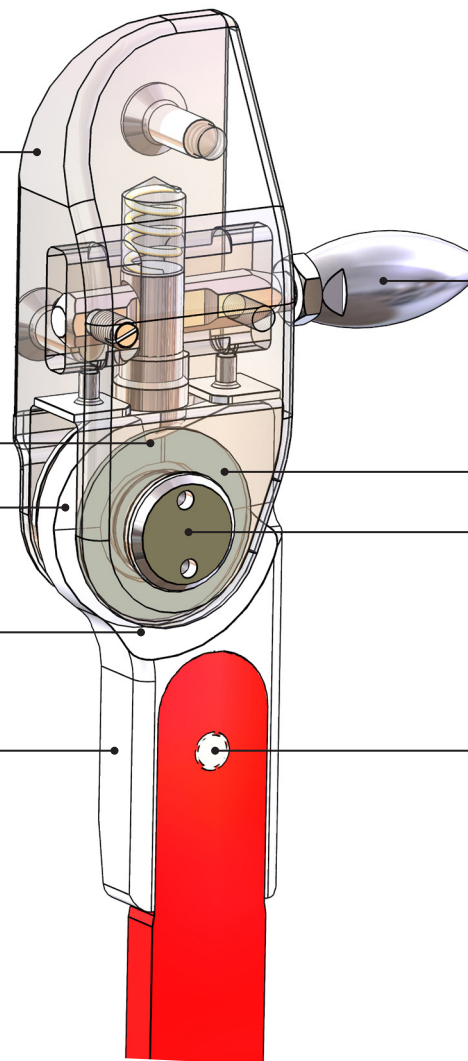
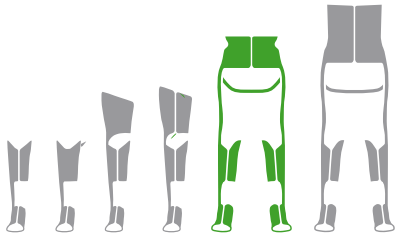

Fig. left

## Standard

- Fully assembled** as one item for clear cost estimates and uncomplicated ordering
- Secure and adjustable** connection to pelvic band
- Unlocking lever can be installed on **either side** of the joint. Spring-loaded mechanism locks automatically when the hip is extended.
- High-strength** steel washers for smooth operation free of play
- Maintenance-free**, high-strength steel joint assembly with self-lubricating bearing
- Machined upright and offset connection ensure **optimal transfer of force**
- Unrivalled **20-month guarantee**
- Engraved **serial number** for traceability
- Clearly illustrated** instructions for use



We recommend using our configurator to make your selection.  
The configurator considers, among other factors, weight to height ratios.

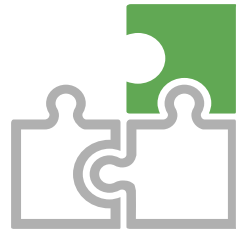

### Weight Classification (body weight)

### Joint

Article No.	HKAFO	Width	Thickness	Height
Fokus-3D-infant	up to 15 kg	25 mm	20,0 mm	94,0 mm
Fokus-3D-klein	up to 20 kg	30 mm	23,0 mm	112,5 mm
Fokus-3D-klein-Plus	up to 30 kg	36 mm	29,0 mm	114,0 mm
Fokus-3D-mittel	up to 40 kg	36 mm	29,0 mm	127,5 mm
Fokus-3D-groß	up to 60 kg	36 mm	29,0 mm	127,5 mm
Fokus-3D-ex-groß	up to 85 kg	45 mm	36,0 mm	151,0 mm

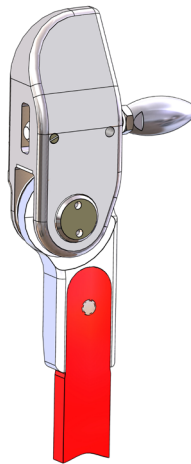

Locked

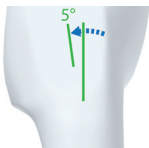

Extension



Flexion

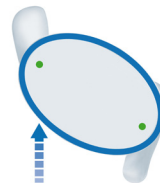

Step Length



with Pelvic Rotation

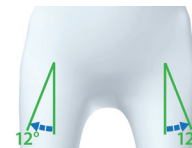

Abduction



and Adduction

No Grinding  
Necessary